

SOCO VERTI

FLEXIBLE
MODULAR
STANDARD
SYSTEM



FLEXIBLE VERTICAL TRANSPORT TODAY AND TOMORROW

Compact lift with high capacity - part of an extensive conveying system.

Flexibility, elegant design, and high safety level are some of the Verti lift characteristics.

The Verti lift is intended to supplement the bulky, inclined belt conveyors for upward or downward transport of units.

The Verti lift transports the units on shelves which travel continuously according to the paternoster principle. A photo-cell registers that a unit is approaching the lift where the unit is picked up when a shelf is ready to receive.

The Verti lift is designed for vertical transport of cartons, pails, plastic trays, etc.

As standard, SOCO VERTI is delivered in RAL 2002, but it is available in other colours at an additional price.

The Verti lift is delivered with handling fittings at the top. The fittings can also be used for securing in ceiling.

The lift works in a continuous cycle. Chains pull up the shelves according to the paternoster system.

The lift is delivered with windows on the front.



With the safety lock, jam injuries are avoided. When lifting the lock, the lift stops. The lift cannot be restarted until the lock is in place again.

The Verti lift is equipped with 4 height adjustable legs which are also used for levelling the lift.



The lift is available in working heights ranging from 1.5 m to 6 m - actual height will depend on the weight of the units and the required capacity.



Technical data

The Verti series is made up of standard modules for transport of units of the following sizes (length x width):

- 400 mm x 400 mm
- 600 mm x 400 mm
- 600 mm x 600 mm
- 800 mm x 600 mm

In principle, the lift consists of three standard modules: Bottom, top, and intermediate modules.

The lifting height is adjusted by means of intermediate modules.

The Verti lift is PLC controlled.

SOCO SYSTEM has developed a programme which calculates which SOCO VERTI will solve the current job best.

Fill in the form on the back and contact our sales department.

Calculation example: SOCO VERTI model SV 8-6-7

Infeed/outfeed height (D)	750 mm
Lifting/lowering height (F)	1140 mm
Infeed/outfeed height (E)	1890 mm
Total height (G)	2701 mm

Dimensional sketch

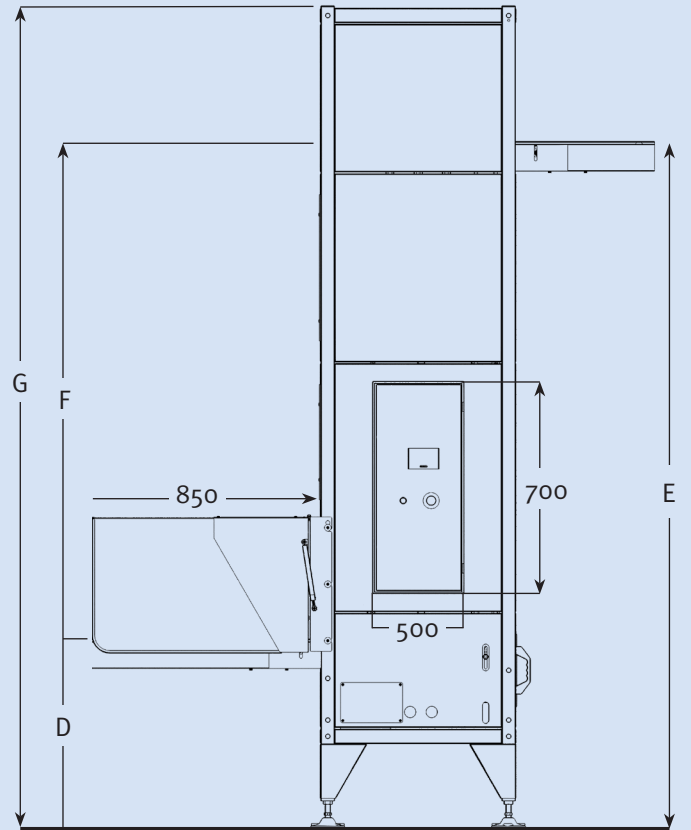

Model		SV 4-4-4	SV 6-4-5	SV 6-6-7	SV 8-6-7
Data	Maximum unit dimensions				
	L	400	600	600	800
	W	400	400	600	600
	H	400	500	700	700
Infeed conveyor	L	500	750	750	1000
	W	400	400	600	600
Dimensions					
Infeed/outfeed heights		490 +/- 50 700 +/- 50 750 +/- 50 850 +/- 50 950 +/- 50			
Capacity		Up to approximately 30 units per minute depending on the height and weight of the unit.			
Voltage		3 x 220 volt, 50/60 Hz or 3 x 380 volt, 50/60 Hz. The lift is PLC controlled.			
Colours		As standard, delivered in RAL 2002. Is available in other colours at an additional price.			

All dimensions are stated in mm.
Subject to alteration.

SPECIFICATIONS

Fill in the form below and mail it to our sales department.

Type of unit

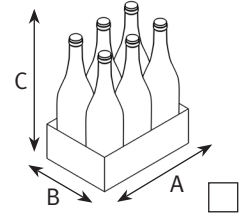
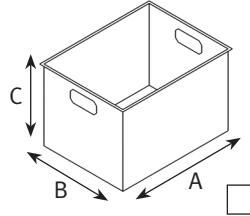
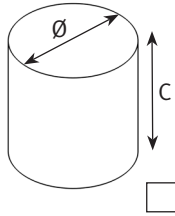
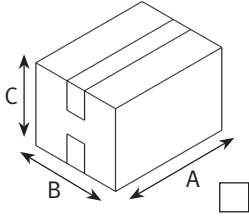

Size of the unit	Length	A	Width	B	Diameter	Ø	Height	C	Weight
Maximum		mm		mm		mm		mm	kg
Minimum		mm		mm		mm		mm	kg

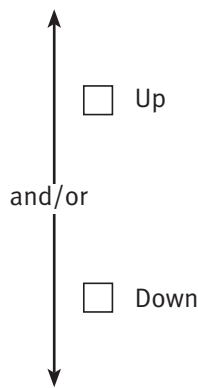
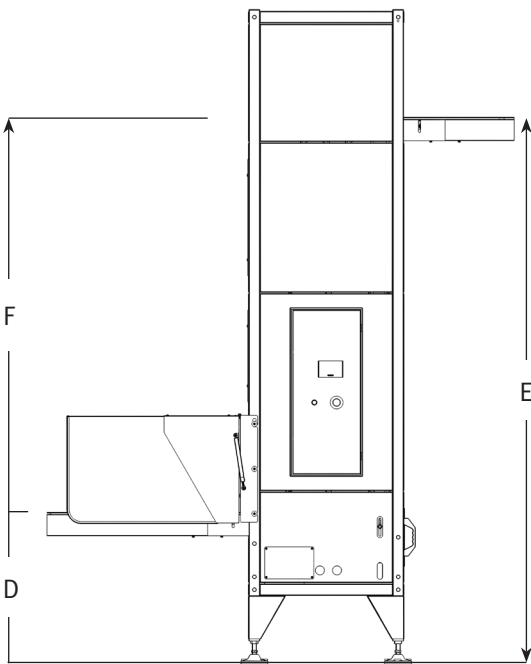

Capacity required: _____ units/minute.

Is there a controller before the Verti infeed?

No Yes

Speed _____ m/minute.

Placing of control cabinet:

Right (as illustrated)

Left

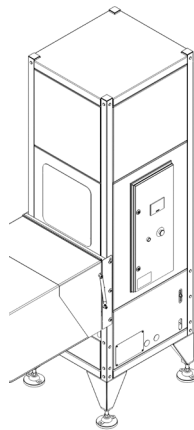

Infeed/outfeed height D	mm
Outfeed/infeed height E	mm
Lifting/lowering height F	mm